

deli

# USER MANUAL

Barcode Scanner No.S226

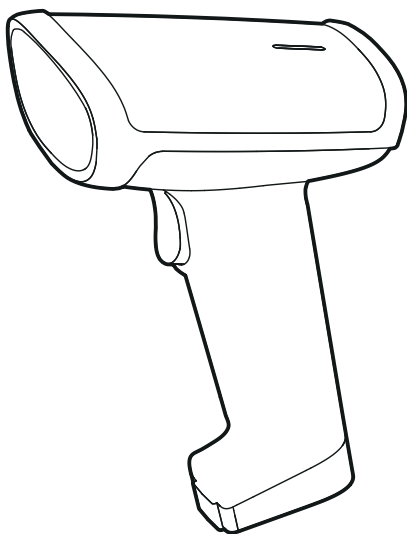

Dear customers, thank you for your purchase of our products. We are committed to providing our customers with high quality products. To ensure best performance, please read this manual carefully before use!

## How to use a barcode scanner correctly

---

1. To read a barcode successfully, please move it closer to the scan window if the barcode is small; otherwise move it slightly further away if the barcode is large.
2. In case of high specular reflection (e.g. laminated barcode stickers) , please tilt the scanner in an appropriate angle to achieve a successful decode.
3. To scan a barcode, aim correctly and ensure the scan line crosses every bar and space of the symbol, otherwise, there might be an error.

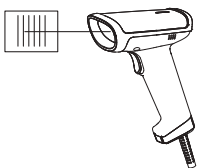

Scan small barcodes from a short distance.

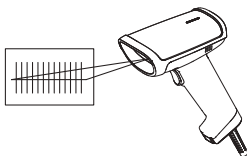

Tilt to read laminated barcodes.

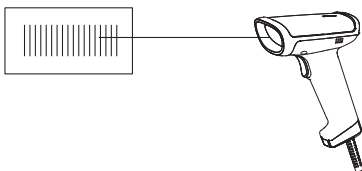

Scan large barcodes from a long distance.

## Overview of scanner parts

---

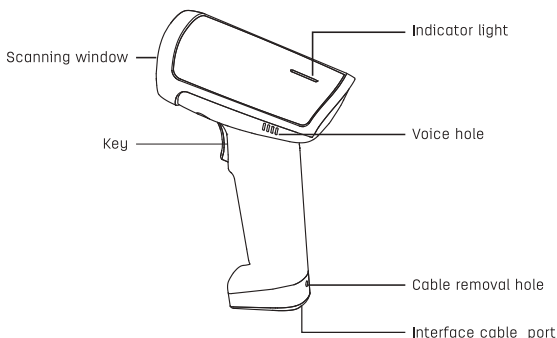

## Removing the interface cable

---

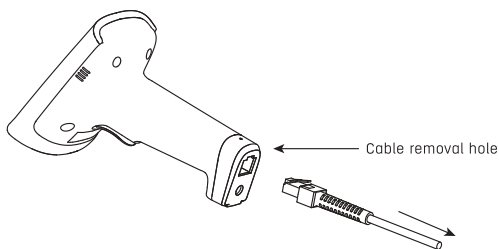

### **Remove the interface cable as follow :**

1. Find the cable removal hole on the bottom of the barcode scanner(as shown in the figure above).
2. Insert a paper clip-like fine needle into the hole, and press the paper clip hard. Meanwhile, carefully slide out the cable from the barcode scanner port.

## Packing list

---

Barcode Scanner×1, USB Cable×1, User Manual×1, Paper Clip×1.

## Technical parameters

---

Operating voltage	DC 5V±0.25V
Operating current	185mA (typical value)
Peak current	210mA
Standby current	≤50mA (Manual Reading Mode)
Light source	White Light LED; Red Light LED
Barcode types	1D&2D code
Resolution	1D code≥4.7mil 2D code≥10mil
Applicable barcodes	1D :EAN13、EAN8、UPC-A、UPC-E0、UPC-E1、Code128、Code39、Code93、CodaBar、Interleaved 2 of 5、Industrial 2 of 5、Matrix 2 of 5、Code11、MSI-Plessey、Standard 2 of 5、Plessey、China Post、Code 16K、GS1 Databar(RSS-Expand, RSS-Limited,RSS-14) 2d : QR、PDF417、DataMatrix (ECC200)、Aztec、Micro QR、Maxicode、Micro PDF417
Operating temperature	0℃~+45℃
Storage temperature	-20℃~+60℃
Operating humidity	5%~90% (No condensated water)
Indication	Buzzer/Indicator Light
Interface type	USB
Scanning mode	Manual/continuous
Anti-shock capability	Pass the 1.2m free fall test

# Set global configuration code

---



Restore factory defaults



Enable all barcodes  
(All supported barcodes are readable)

# Decoding sound setting

---



Turn on decoding sound



Turn off decoding sound

# Reading mode setting

---



Manual read mode



Automatic continuous reading

# Common suffix setting

---



To add a carriage return suffix



To add a carriage return  
and a line feed



To add a tab



Disable suffix

# Troubleshooting

NO.	Problem	Possible Causes	Solution
1	Interface cable installed properly, but no white supplement light	No power to the scanner	Ensure the host is plugged in and turned on. When using the USB cable, plug it into the computer's motherboard USB ports, no extended USB ports or USB extension cord should be used.
		The interface cable is not connected properly	Check for loose cable connections.
2	White supplement light comes on, but the barcode cannot be read	Scanner is not programmed for this type of barcode	Scan the setup symbol to enable this type of barcode.
		The barcode is defaced	Try scanning test barcode of same barcode type.
		Distance between scanner and barcode is incorrect	Move the scanner closer to or further from the barcode.
		Distance between scanner and bar code is not enough and the scan line is not crossing the full code	Aim at the barcode before scan.
3	Scanned data is incorrectly displayed on the host.	Incorrect input method	Change the input method to Standard English.
		Other scanner settings are changed	Restore the scanner to factory defaults, or contact the manufacturer service center.
4	Scanned data is displayed as messy code or an error	The keyboard country is improperly configured	Select the keyboard layout of your country.
5	Other decoding failures	Connection errors	Disconnect power supply; reconnect host cable; reconnect power supply; restore factory defaults and re-scan the barcode.

## Simple maintenance methods

1. Stains and dusts on the scanning window can sometimes affect the scanner's performance. Please use good-quality tissue to gently wipe the scanning window and then blow any excess dust from the window using a dust blower. Use of poor-quality tissue for a long period of time will damage the surface smoothness and affect reading accuracy.
2. The shell of the scanner may be cleaned with a soft cloth. If needed, clean the exterior using a soft cloth with a mild detergent-water solution .

## Maintenance

---

1. For product failures occur under normal operating circumstances, free of charge repair service shall be provided by our company within one year commencing from date of purchase.
2. The period of warranty shall start from the date of purchase and invoice date.
3. Customers are required to present the warranty card and the invoice upon request for repairing service.
4. Please keep this warranty card in proper condition for free warranty service. There is no replacement if lost. The purchase date filled must be consistent with what is indicated in the invoice, otherwise it will be invalid.
5. Any alteration to this warranty card renders it invalid.
6. Our Repair Service Center will be glad to provide services to customers for out-of-warranty products.

**Under any of the following circumstances, no free of charge repair service shall be provided:**

1. The warranty period has expired.
2. The user cannot present the invoice or dated proof of purchase.
3. The user requires a replacement of the product with the excuse that the product appearance looks old naturally due to use.
4. Machine failure is caused by use in violation of instructions.
5. Machine failure is caused by falling or collision.
6. Machine failure is caused by self-assembly, self-dis-assembly and self-repair.
7. Commercial samples and goods sold at reduced prices, as well as products that have undergone performance overload tests.

**★ Note: The information in this document is subject to change without notice.**

# The table of toxic and hazardous substances/elements and their content

Part name	Hazardous and noxious substance or elements					
	Pb	Hg	Cd	Cr(VI)	PBB	PBDE
Cable	○	○	○	○	○	○
Electronic parts	×	○	○	○	○	○
Injection molded parts	○	○	○	○	○	○

○: Indicates that this toxic or hazardous substance contained in all of the homogeneous materials for this part is below the limit requirement in SJ/T 11363-2006 «Requirements for Concentration Limits for Certain Hazardous Substances in Electronic Information Products».

×

Indicates that this toxic or hazardous substance contained in at least one of the homogeneous materials used for this part is above the limit requirement in SJ/T 11363-2006 «Requirements for Concentration Limits for Certain Hazardous Substances in Electronic Information Products». Due to limitations of science and technology development, these toxic or hazardous substances cannot be replaced or reduced for now. Under normal use conditions, no leakage or abrupt change will occur within 10 years, nor will it cause pollution to the environment or damage to people and property.

 Environment-Friendly Use Period:

This mark refers to the environment-friendly use period of electronic and electrical products sold in accordance with the Regulation of the People's Republic of China on Limit on Use of Hazardous Substances in Electric and Electronic Products and General Guidelines of Environment-friendly Use Period of Electronic Information Products.

## Special disclaimer

While information of this manual has been carefully checked for accuracy, no guarantee is given for the completeness and correctness of the contents. Such errors and omissions will be corrected in the new edition of user manual without further notice. The intellectual property of this manual belongs to our company and no organization or individual is allowed to change the content.



**WARRANTY CARD**

Customer Name		Phone		Postcode	
Mailing Address					
Product Name		Model			
Date of Purchase					
Province		City/town			

**REPAIR FORM**

Date	Description	Replaced parts		Maintenance Technician
		Name	Quantity	

★ For any question, please contact your local dealer.

## CERTIFICATE

Inspector: \_\_\_\_\_

Date of manufacture: \_\_\_\_\_

### DELI GROUP CO., LTD.

Deli Industrial Zone, Ninghai County, Ningbo  
City, Zhejiang Province, China Made in China  
info@nbdeli.com      www.deliworld.com



**KEEP FOR  
FUTURE USE**

Version: 1.0  
Date: 04-2024